



MU-1 SLD M

SPECIFICATIONS

Nominal Voltage (V) 12V

Nominal Capacity

20 hour rate (1.7A to 10.50V)	34Ah
10 hour rate (3.4A to 10.50V)	32.3Ah
5 hour rate (5.78A to 10.20V)	28.9Ah
1C (34A to 9.60V)	15.3Ah
3C (102A to 9.60V)	11.9Ah

Weight Approx. 24.44Lbs. (11.11kg)

Internal Resistance (at 1KHz) 9 mΩ

Maximum Discharge Current for 30 seconds : 680A

Maximum Discharge Current for 5 seconds : 1360A

Operating Temperature Range

Charge	0°C (32°F) to 40°C (104°F)
Discharge	-15°C (5°F) to 50°C (122°F)
Storage	-15°C (5°F) to 40°C (104°F)

Charge Retention (shelf life) at 20°C (68°F)

1 month	92%
3 months	90%
6 months	80%

Charging Methods at 20°C (68°F)

Cycle Use : Charging Voltage 14.4 to 15.0V
Maximum Charging Current : 10.2A

Standby Use : Float Charging Voltage 13.50 to 13.80V

Life expectancy :

Cycle Use : 100% depth of discharge 225 cycles
80% depth of discharge 250 cycles
50% depth of discharge 750 cycles

Standby Use : 3-5 years

Case Material : ABS
(Option : 94-HB & 94V-0 Flame Retardant Case Material)

Terminal : F4

Maintenance-Free Rechargeable Sealed Lead-Acid Battery



DIMENSIONS

mm(inch)

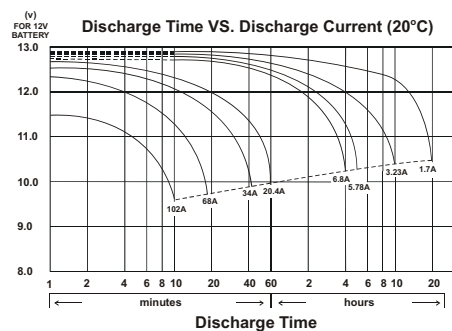
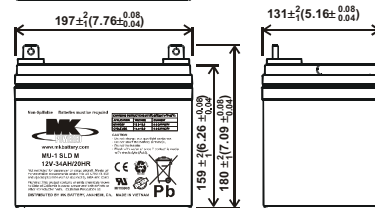
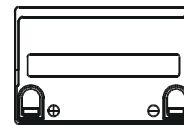
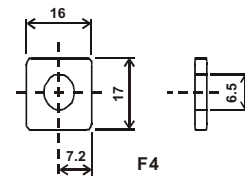

MK Battery

1631 South Sinclair Street • Anaheim, California 92806

Toll Free: 800-372-9253 • Fax: 714-937-0818 • E-mail: sales@mkbattery.com

